

Pulsating heart

- Anna Kalwoda | 11707193
- Roman Gattermann | 12003432
- Kőházi Balázs | GVD24J
- Jánosi Zita | C4G3PR



Analysis

- Usage of roads
 - Mostly car oriented although it's the central park of the area
 - Unsafe for kids – Nursery, school
- Buildings
 - Mostly lower building heights
 - Flat roofs
 - Ground floor: store/garage



Parking

- More convenient to use car
- All parking spots are very overcrowded



Source: own fotos; openstreetmap.com; own visualization

Public Transportation

- No frequent buses
- No micromobility points
- H5 is overcrowded
- Public transport is inconvenient

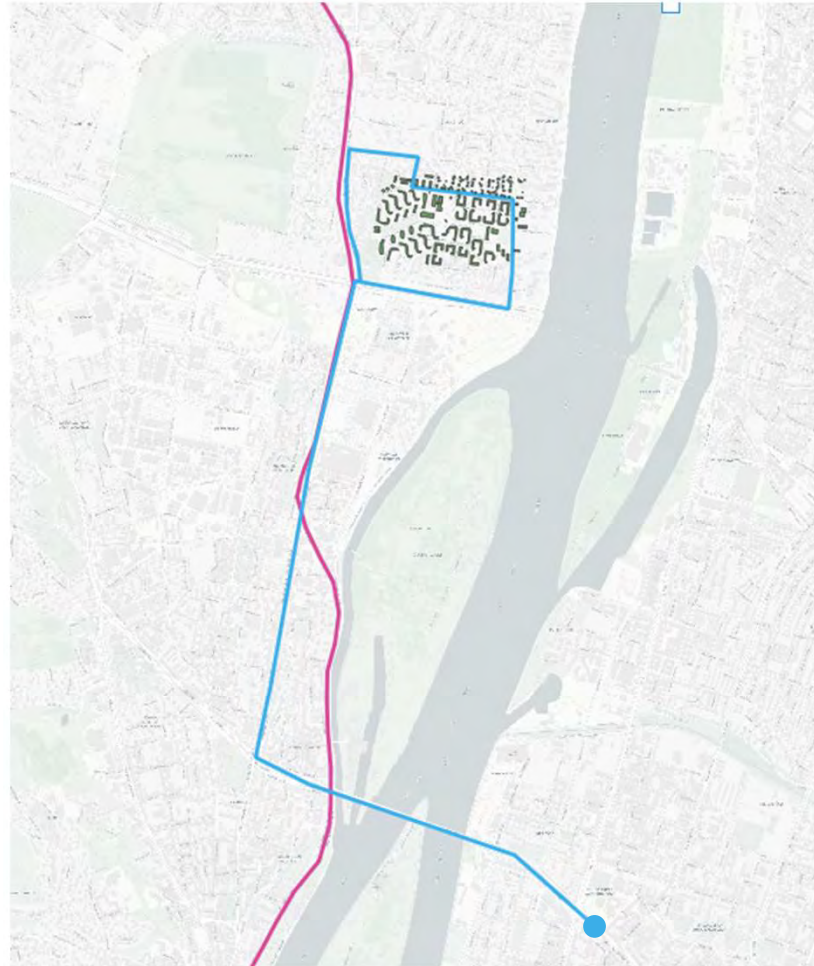

Source: bkk.com

	106				
6	00	20	35	51	
7	16	34	46		
8	05	18	34	50	
9	05	20	35	50	
10	05	20	35	50	
11	05	20	35	50	
12	05	20	35	50	
13	05	20	35	50	
14	05	20	35	50	
15	05	20	35	51	
16	06	21	34	48	
17	01	14	28	41	53
18	07	20	35	50	

Facility map:

- Shops
- Educational facilities
- Traffic infrastructure
- Free gym
- Water hydrant

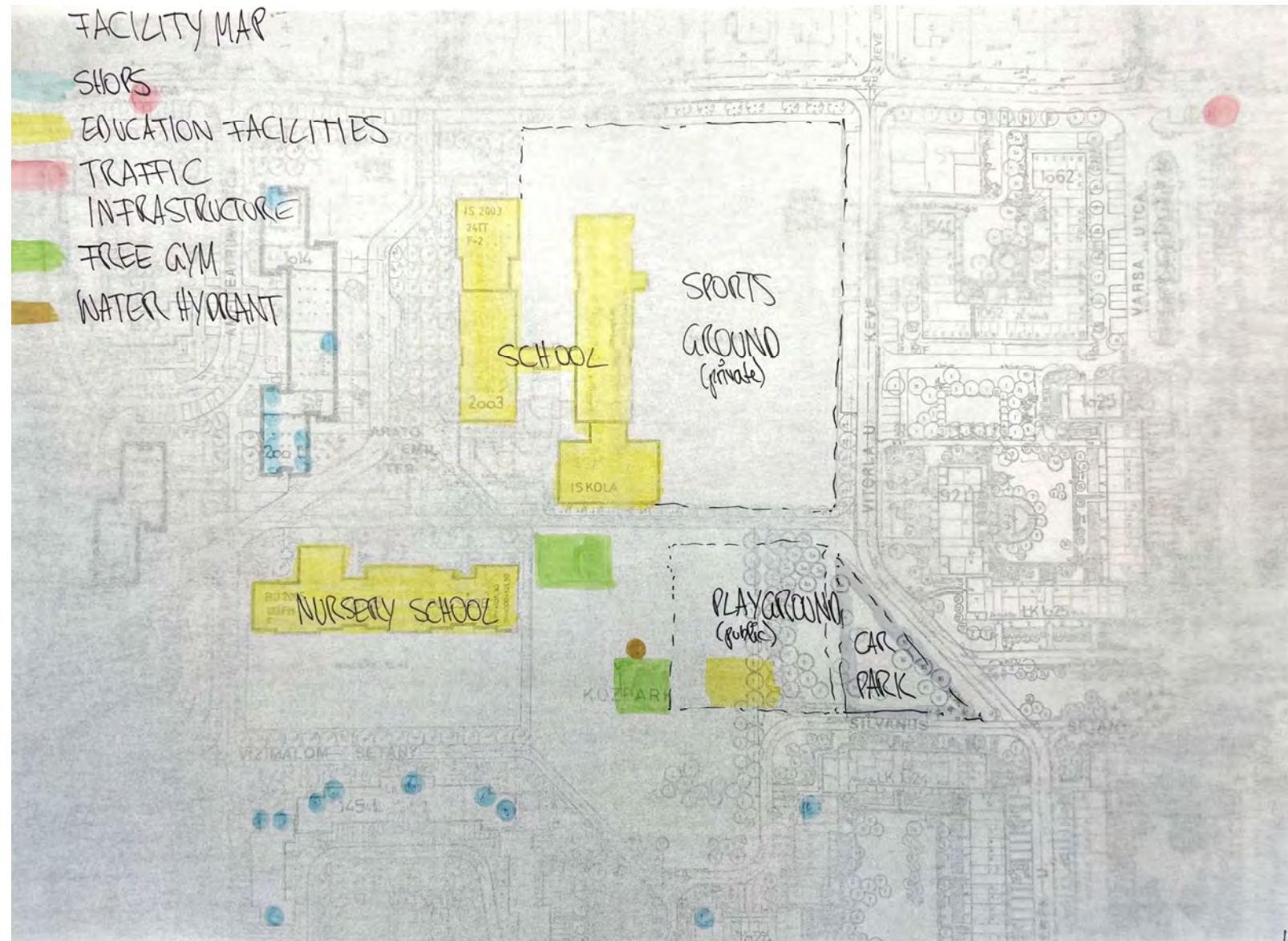

Green Areas and car park

- Fragmented
- Enclosed by streets and fences
- Unclear functions
- Rich green infrastructure
- Unused areas

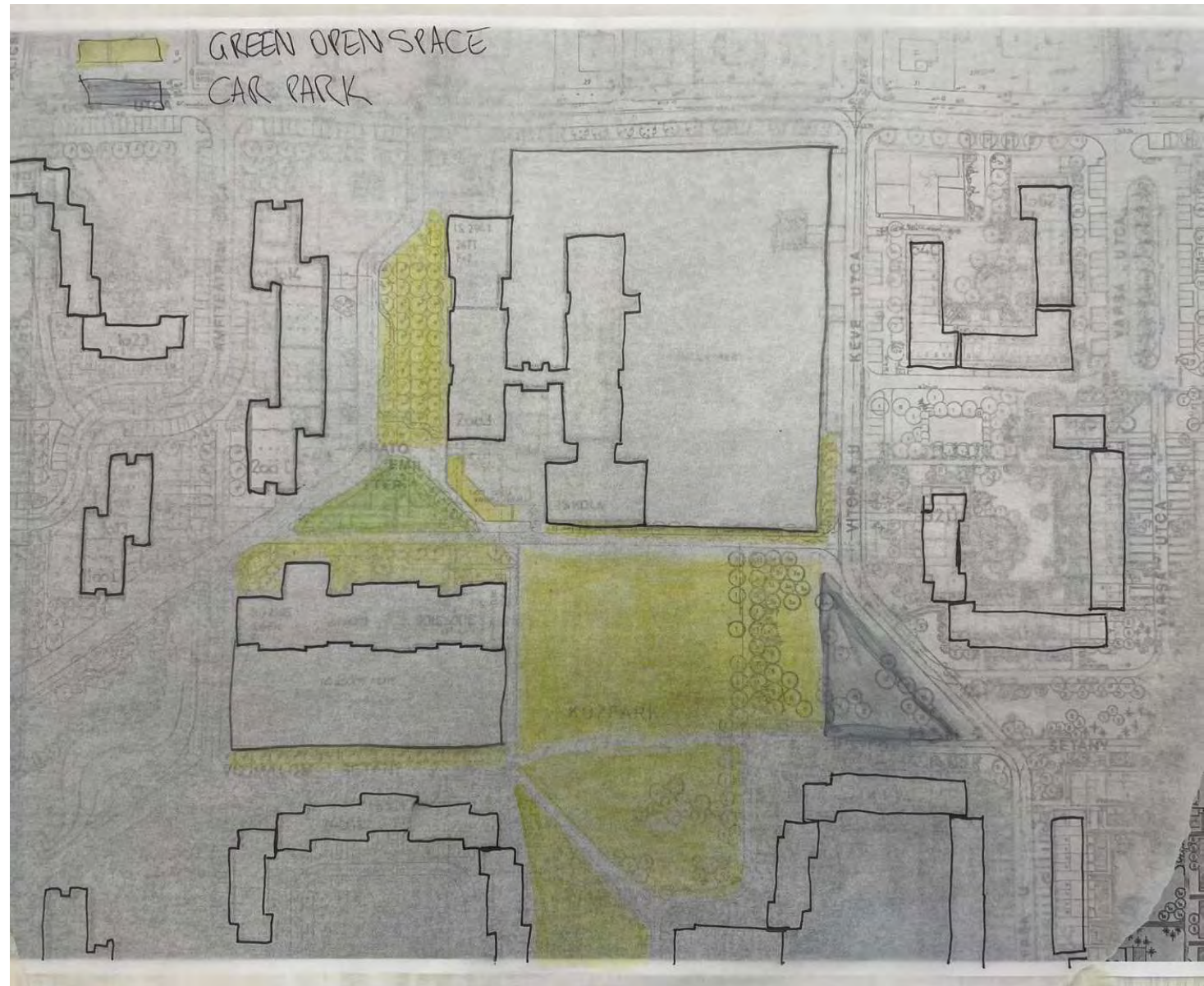

Concept Areas

Connectivity

Pedestrian Friendly

Pedestrian Focused

Reduced Traffic Area

Safety

Bike station

Sport

Gathering and resting area



Source: <https://www.google.com/maps/>; own visualization



Concept area 1: Flats

The space in between the flats and the school is crowded with cars and the meadow next to the school building is underused. As the area lacks of enough attractive green open space, we want to give back the space to the inhabitants to spend time, rest, walk their dogs, ... by removing the cars park and planting a second tree avenue



Source: <https://www.google.com/maps/>; own visualization

Concept area 2: School

In the proximity of the school-building and Kindergarten, cars will be removed. There will be place for the parents to drop off their children and then turn around, as well for suppliers of the supermarket close by to deliver their wares, but except for this, this place will be reserved for pedestrians, with a special focus on children.

Source: <https://www.google.com/maps/>



Concept area 3: Free gyms

the user experience at the artificial hills and the training area can be improved, these parts will be equipped with trees for shading, borders will be removed to create a huge open middle



Concept area 4: Sports and brightening up

The current usage of this plot consists for once of installations made by the residents, an open field where children are playing soccer and a rather dark spot in the back

To improve this, proper playground equipment, and a barrier between the street and the field will be built. In the back, some of the shrubs will be removed to make it more accessible.

With this, it will become more attractive for the residents.



Future

Cars

Pedestrians

Mixed Use
(delivery allowed)

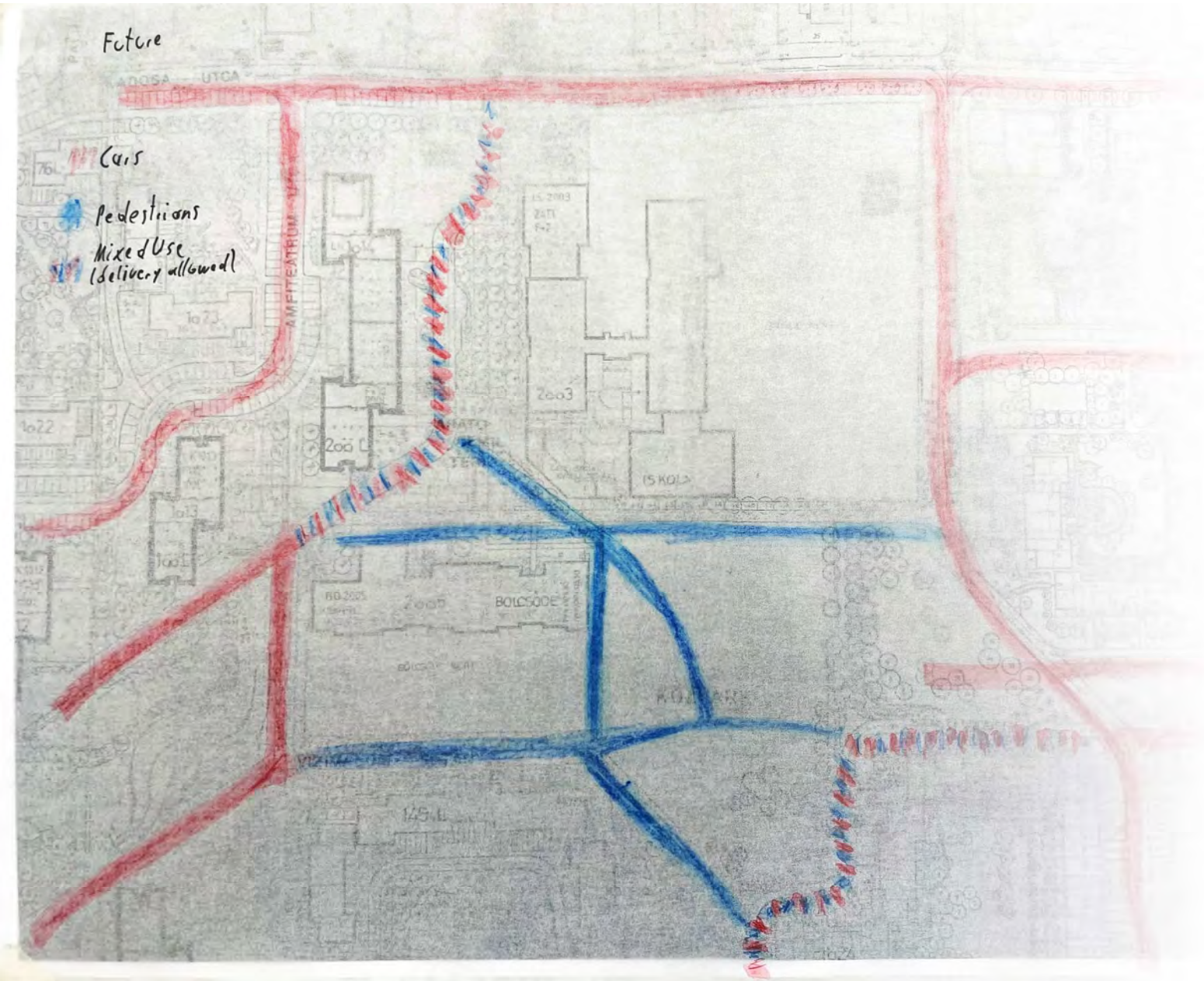

Plans for the Future

- Less cars
- Fewer parking lots
- More pathways for pedestrians
- Connect meadows
- Improve safety

Concept tools

- 4 zones become 1 zone
- Removing cars
- Smooth street level
- Connecting zones by one pavement
- New paths
- Opening up borders
- Giving green back to the houses
- Open middle
- Plant trees for shading

Source: own visualization





Concept Pulsating heart

Vibrant, pulsating heart in the center spreading over the whole site



Second tree avenue, seating possibilities, calm area next to school

Center of the pulsating heart because of the nearby education infrastructure and not only streets crossing, benches, bike station, gathering area

Open middle for individual activities, public playground, shielded from the car park, trees for shading

lighten up the dark area and connect it with the open middle

Connection

By bringing the pathways on the same level as the surrounding green spaces, the area will be opened for both residents and visitors. By using the same material that was already used in other parts of the project area, the new routes will perfectly fit into their surroundings.

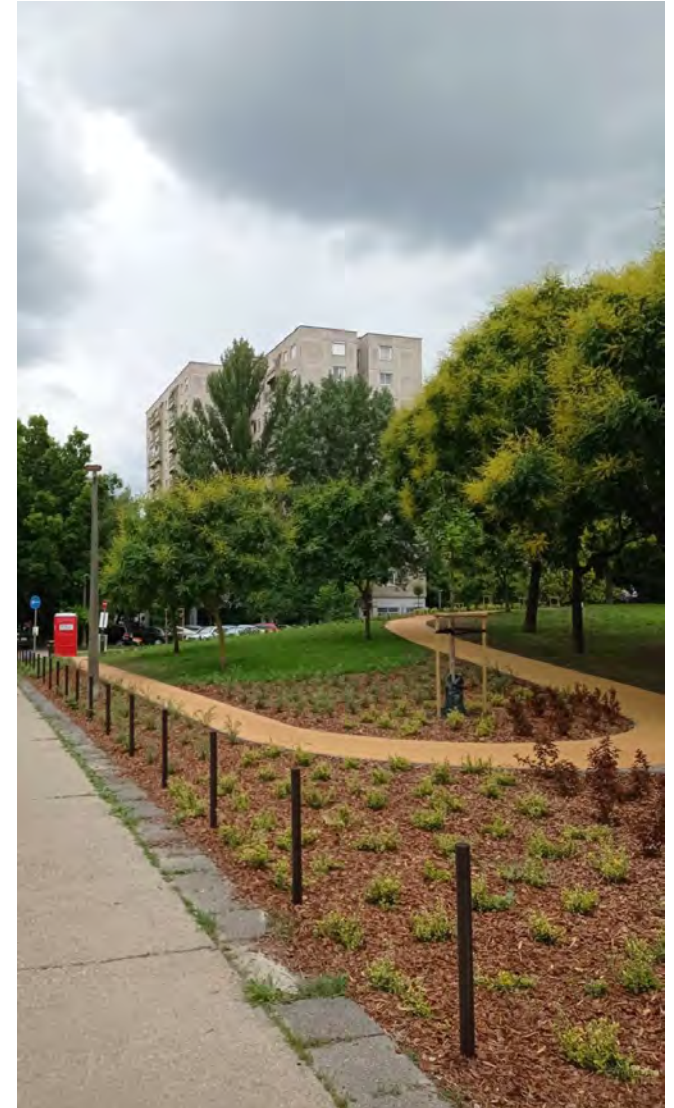

Source: pinterest.com; terraaway.eu/product-information, own foto

Mobility and rest

With a bike locker and a Mol Bubi station, the residents will be motivated to use bicycles rather than cars.

In front of the school, a relaxing seating spot will be created so parents and children can both relax here.



Thank you!