



Connect Rennbahnweg Safely

BOKU University Wien

MATE Budapest

10.05.2024.

Agnes Orosz, Aron Gal, Emma Baumgartner, Florian Wiesenhofer



2. The process

Sketches of the main ways

Main directions
Comparing the past maps
with the current status

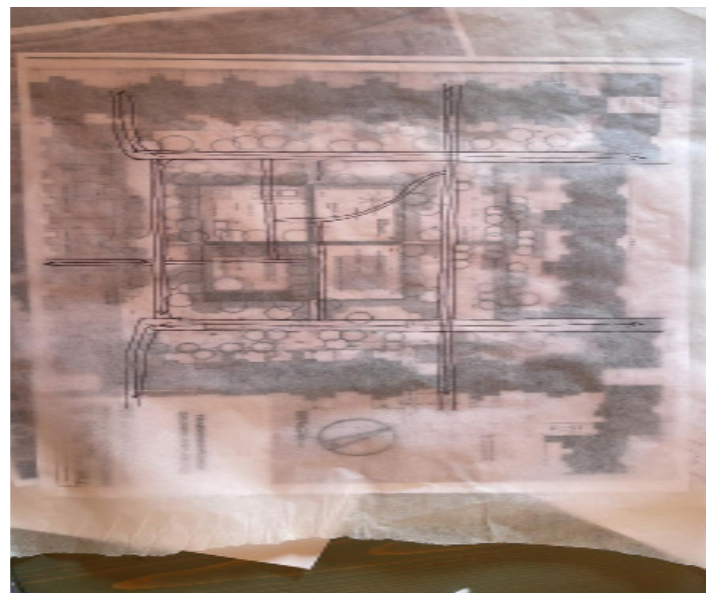

Sketches of passages, entrances

Main entrances
private-semi private passages
Main accessibility

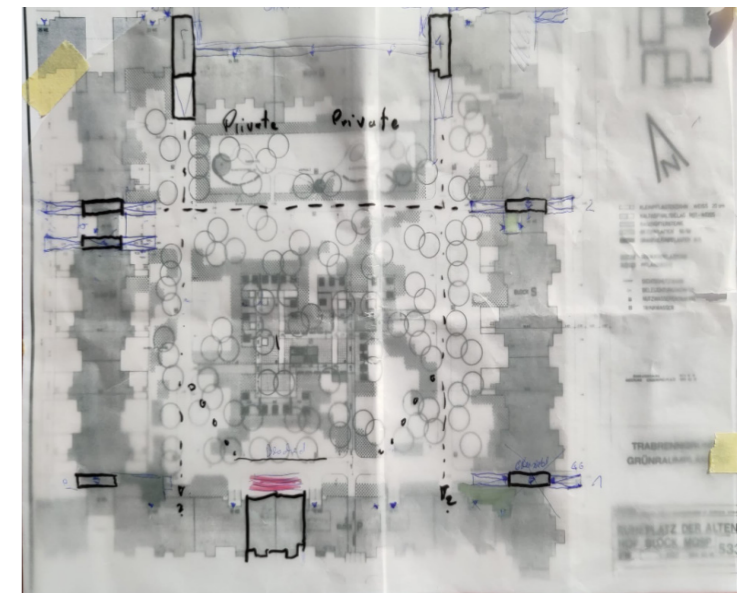

Passage typology

Walking around
Pictures
Determined the main types

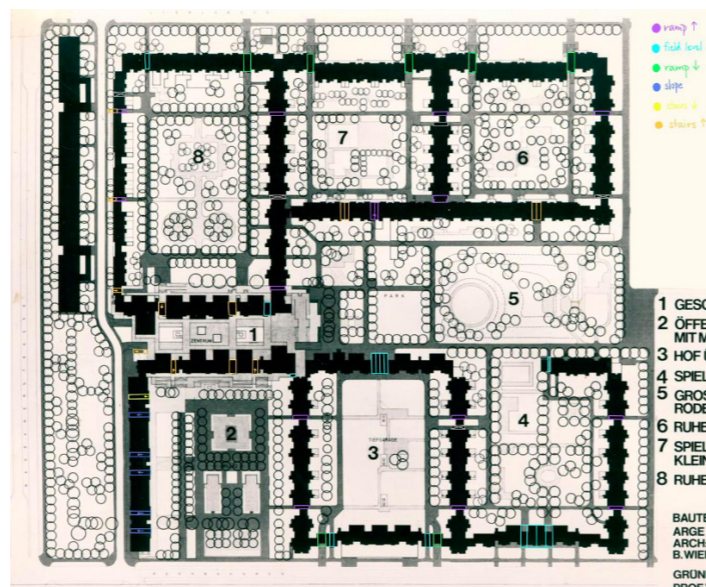

Main routes

Counting in the same time in
all of the areas
Handdrawing routes

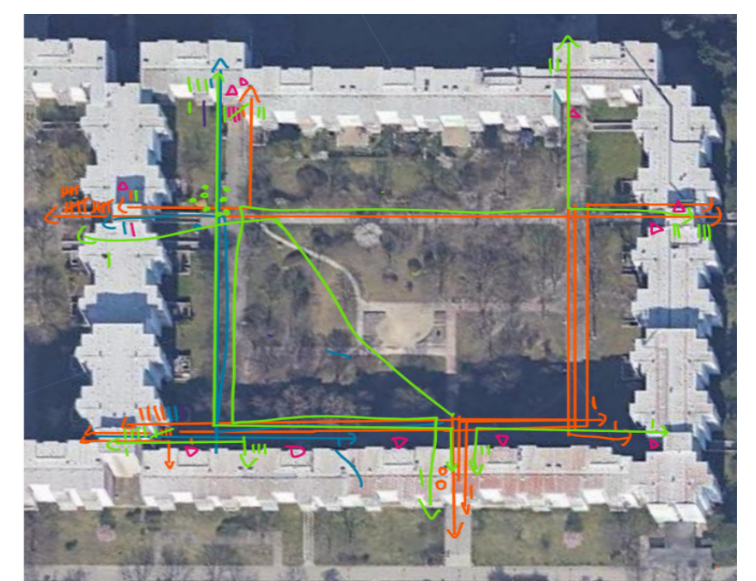

3. Vision and Design Tools

Mixed Use



Semi-public Spaces

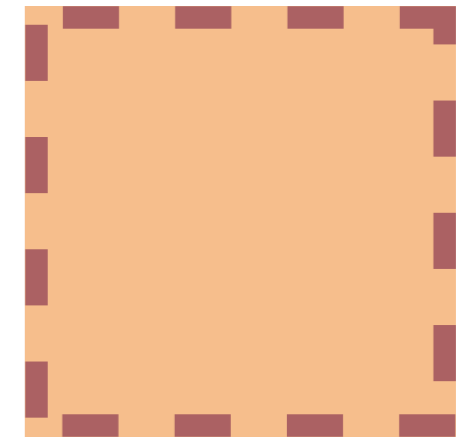

Remove Barriers

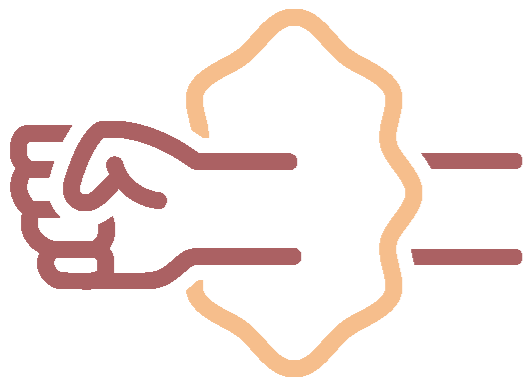

Participation

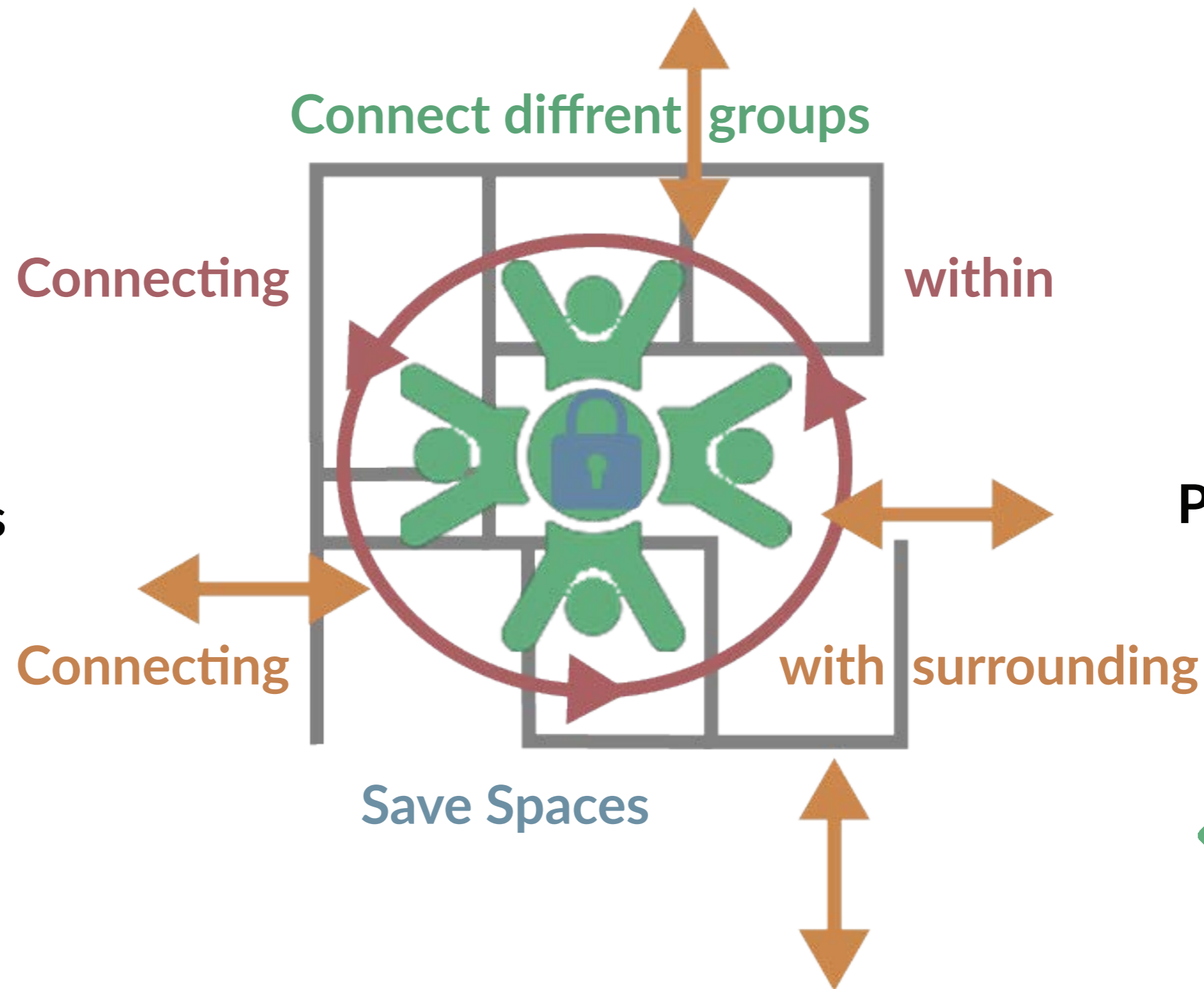

4. Passages Typology

Types of passages

Categorize the main types and characters of passages

The types of the passages are fitting the character of the building

There are some mixed types passages

The main types

Ramp
Stairs
Slope
Passages

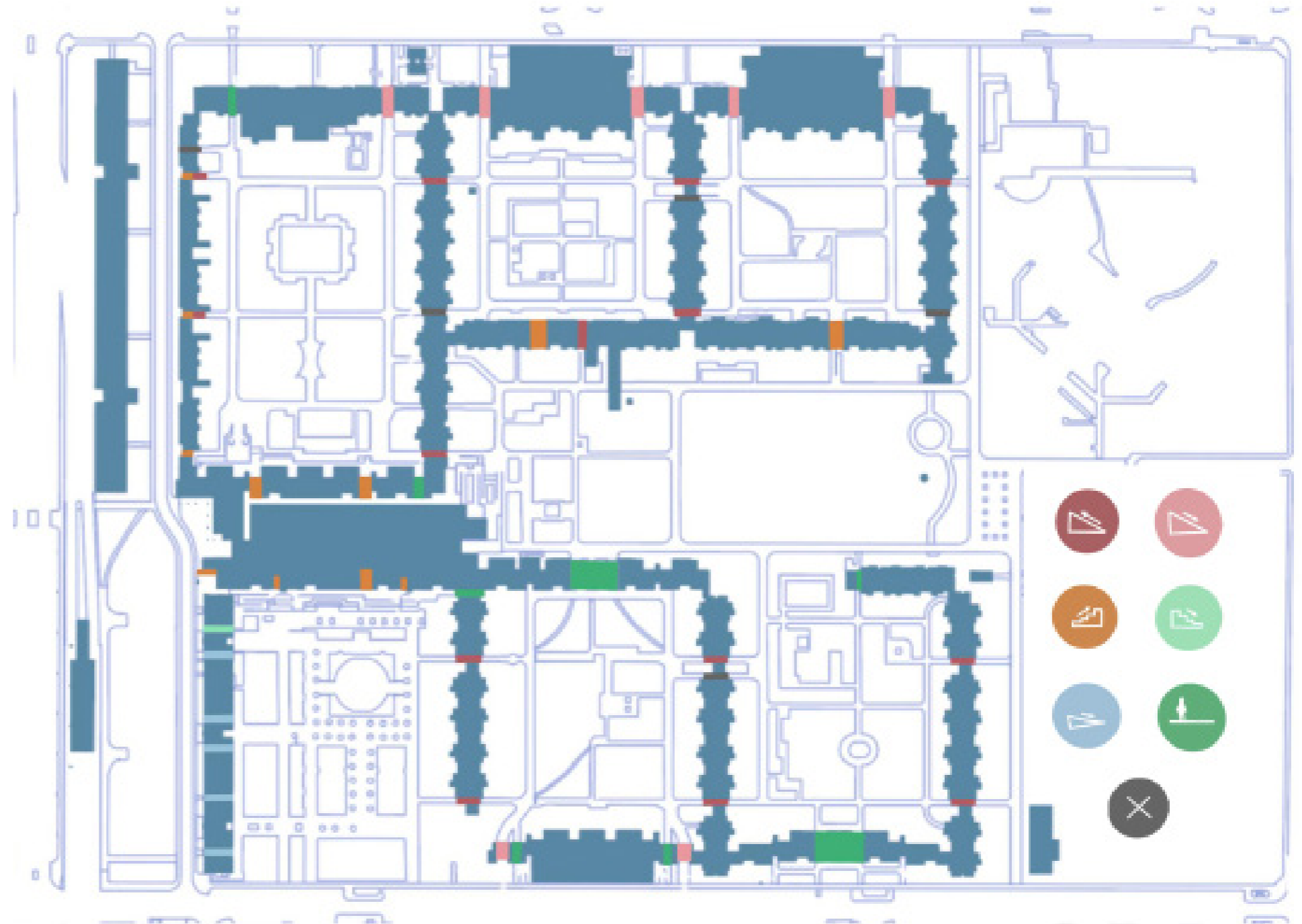

5. Analysis of walkingways

Analysis (1 hour of counting and watching people moving around the courtyards)

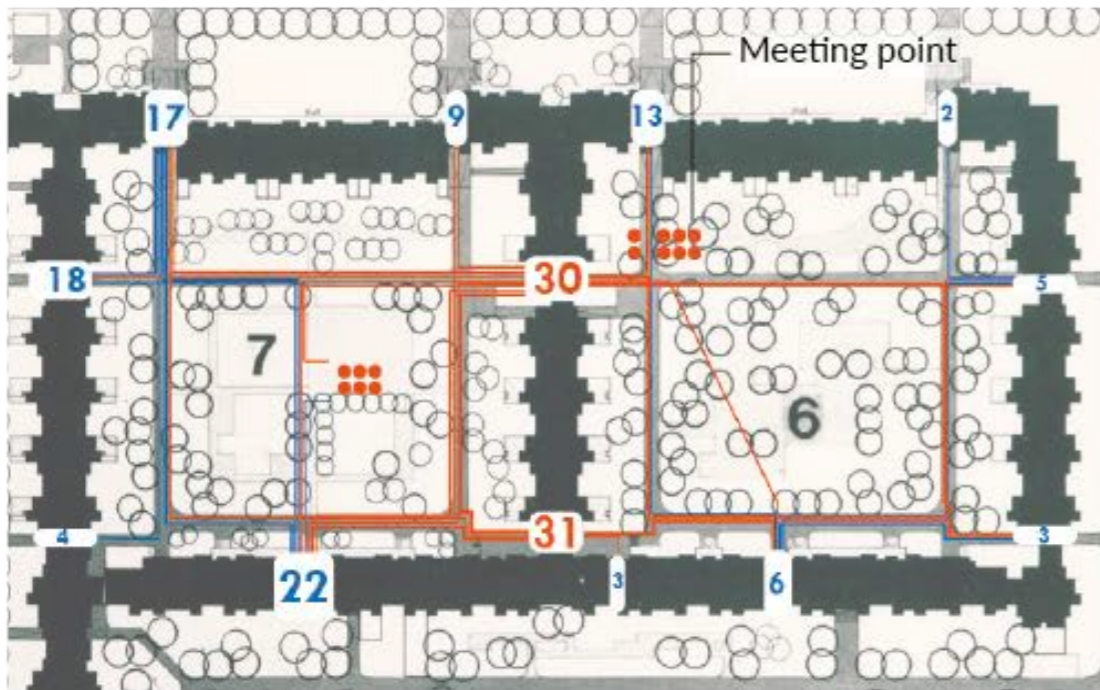

- High number of people moving across the courtyards
- High number of people moving across between 7 and 8 courtyard in the small passageway
- Horizontal and vertical movement
- Meeting points in 6 and 7

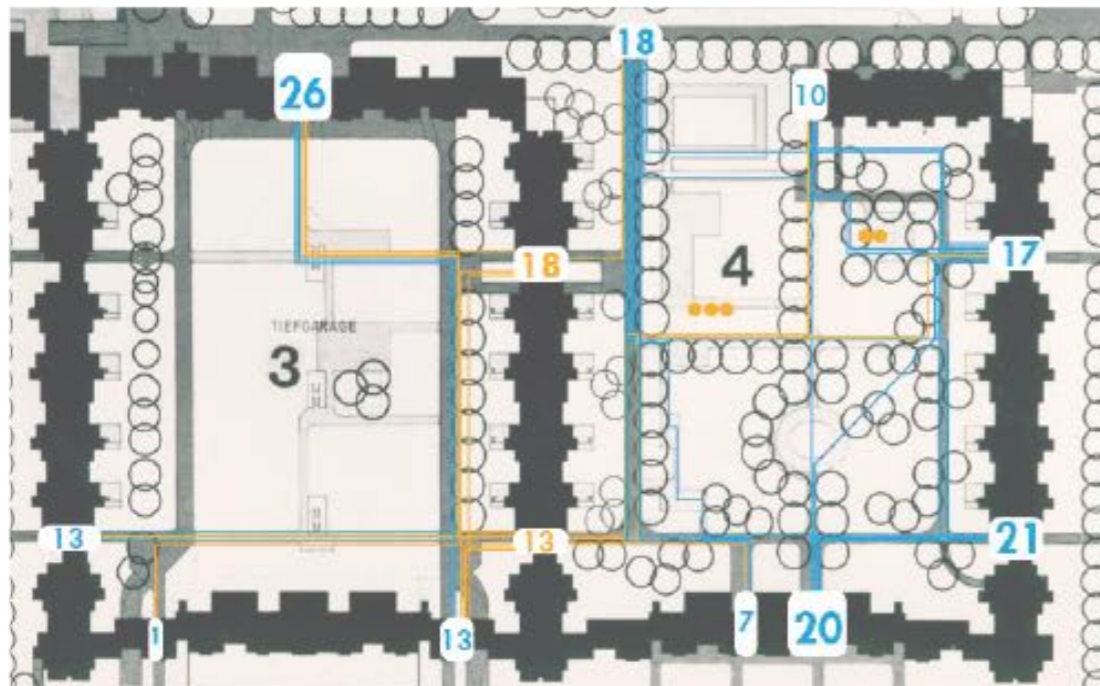

- More people moving vertically
- Less people moving across courtyard 3 and 4
- Meeting point in 4

People's typical movement patterns

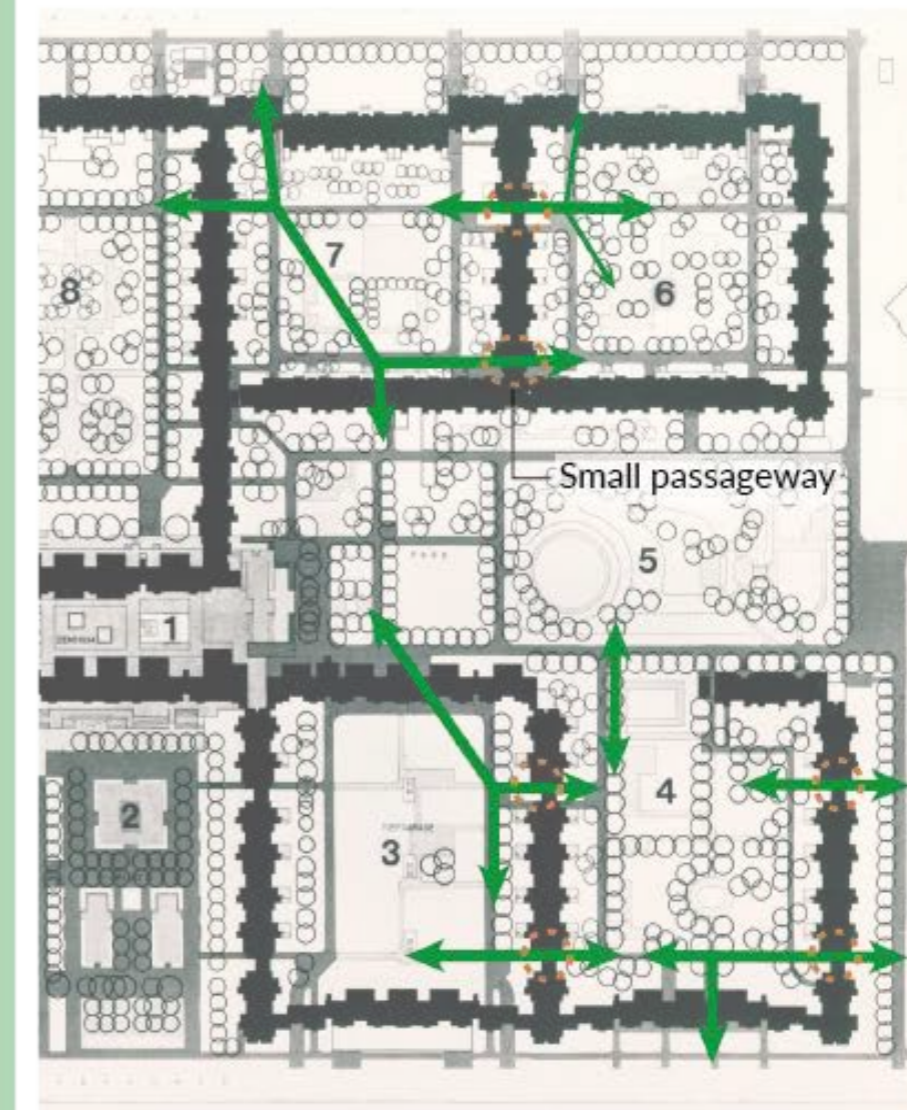

- People crossing courtyard 7 to get to the bus stop or get to courtyard 8 and 6
- People crossing courtyard 3 and 4 to get to the bus stop and get to the school
- The most used passageways are small and narrow

6. Entrance Typology

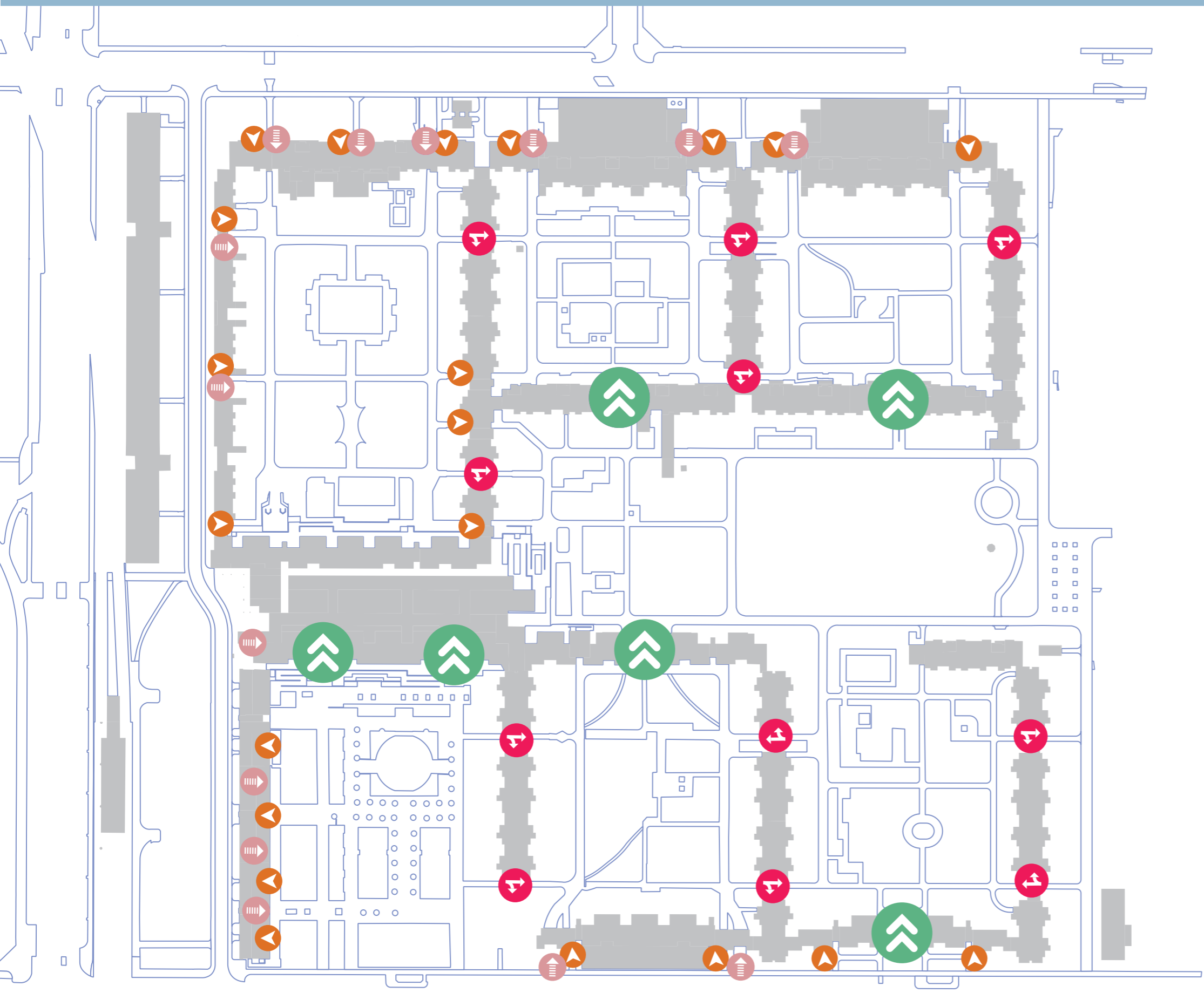

Big Passage



Entrance and Passage



Small Passage



Entrance

7. Path and Entrance Interventions

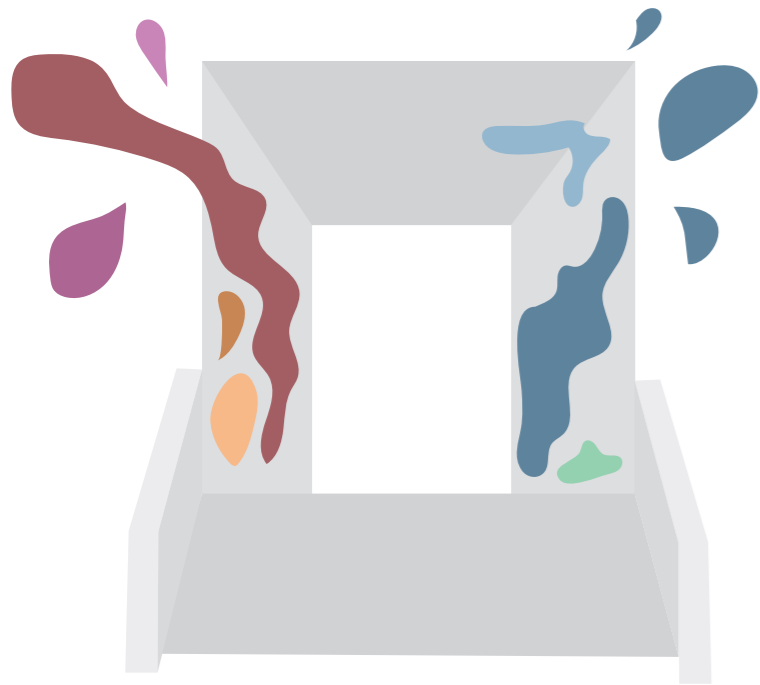

Colour

interventions should transform dark passages and entrances into more attractive spaces

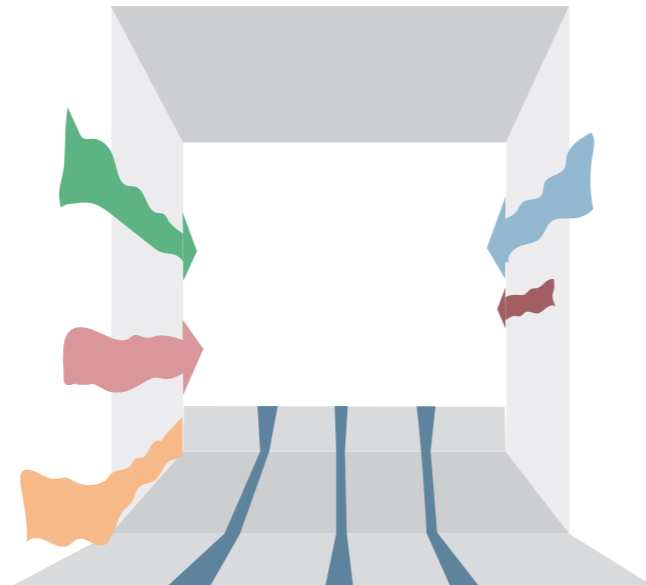

Indications

to highlight the path systems and create differentiated passages

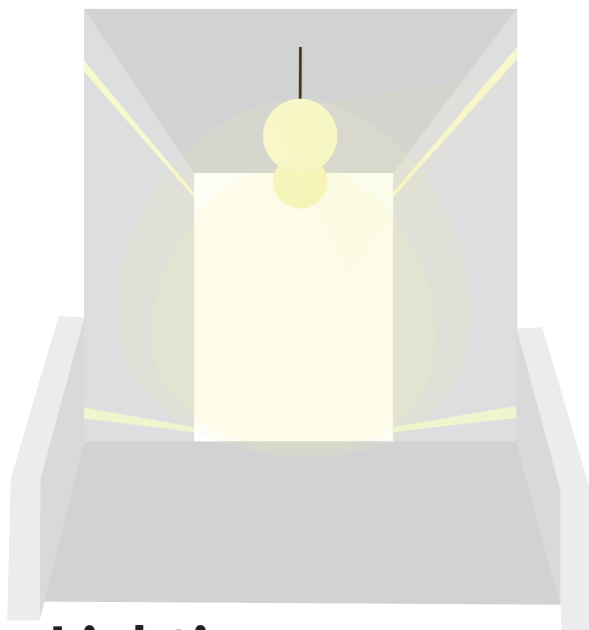

Lighting

should make the paths feel more open and promote safety

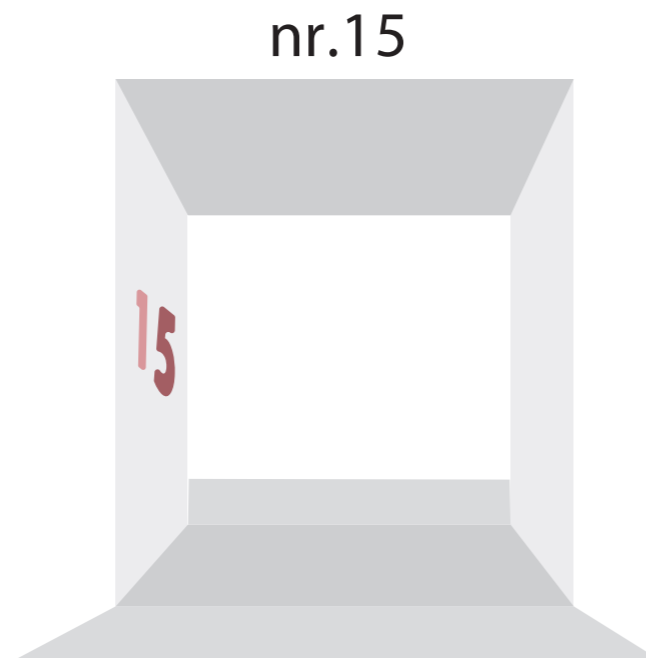

Signs

clear signs to make navigating throughout the area easier and promote residential identity

Creating small interventions using colour, light and clear signs to create the feeling of safety and easy orientation throughout the courtyards.

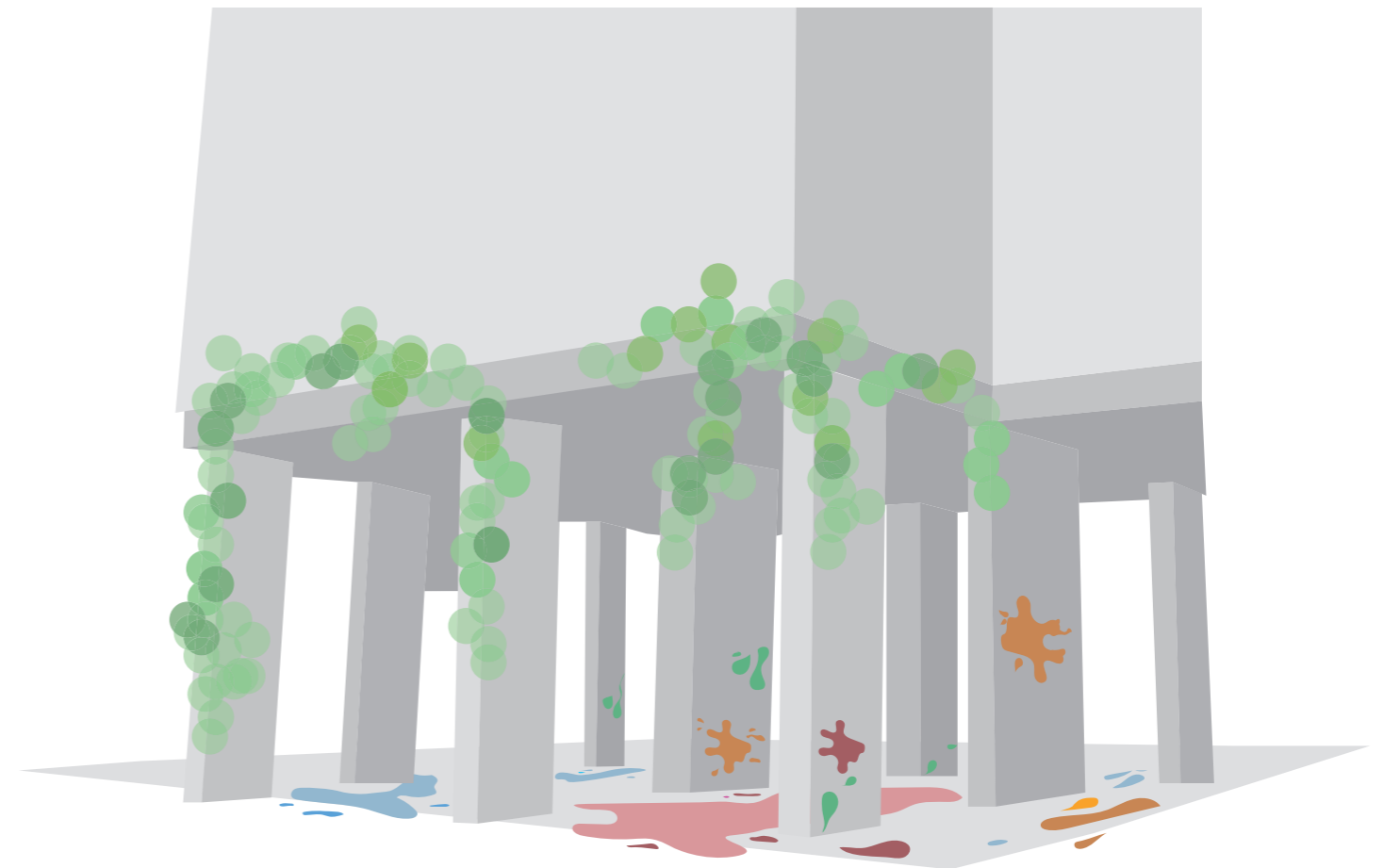

Greening & Colour

Implementing green facades and colour to create attractive spaces between courtyards and strengthen the connection between them

8. Green Infrastructure

Moving shrubs



Moving shrubs from the middle to the courtyards to the boundary (original plans):

- free open and save room in the middle
- blocked view to the building (countryside feeling)

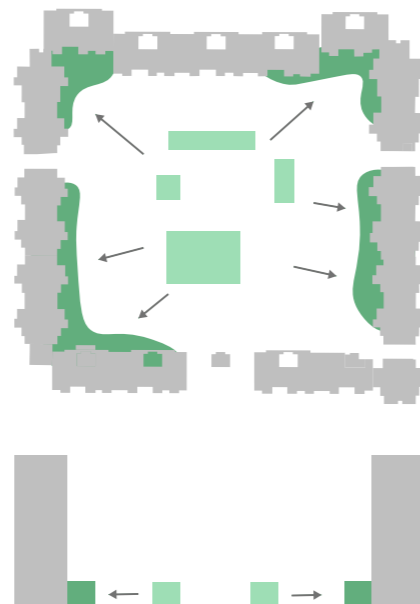

Reconstruct Tree lines



Reconstruct the tree lines, realise the originally intended guiding of trees alongside of paths

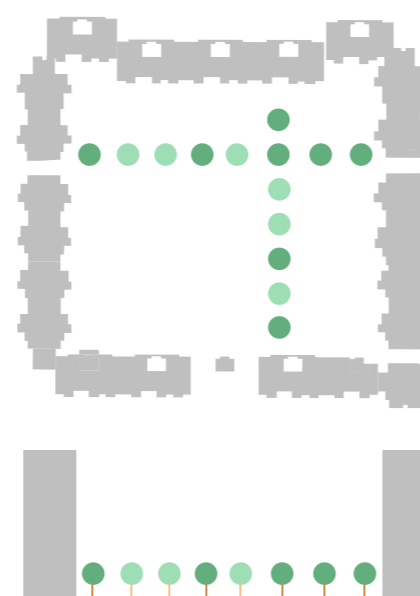

Rethink Lawn



Plant a flowering meadow at parts that are not used:

- Spaces get structured and more functional
- flowering meadow creates countryside feeling

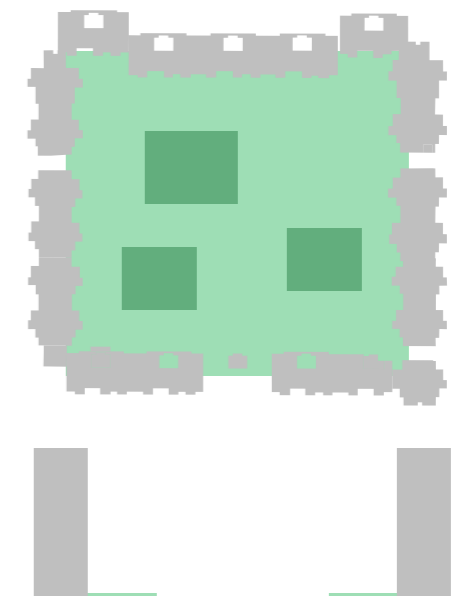

Green Facades



Make the entrances more visible with Green facades w

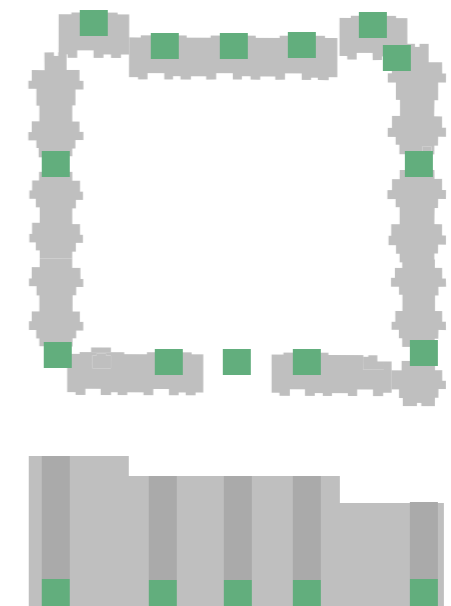

9. Mixed Use

Shops and other stores

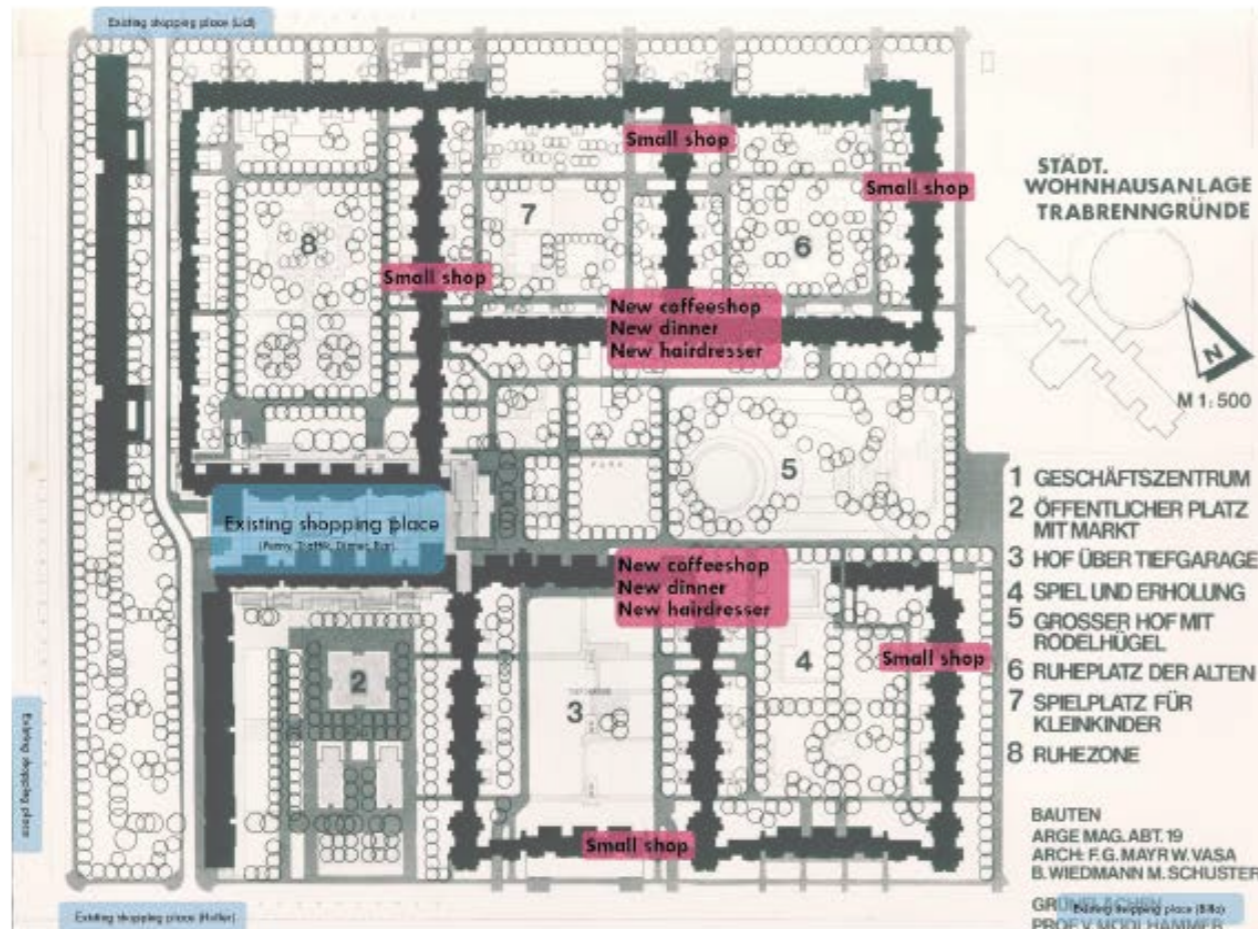

- The blue bubbles are indicates the existing stores and the red bubbles are indicating the needed new functions and stores
- The new functions placed where are missing functions and this creates a compact and lively neighborhood
- The new foncions are creating new communal and meeting sapces around them and the resident don't have to leave the estate to have a coffie or have a dinner

New needed communal spaces and infrastruc-ture elements

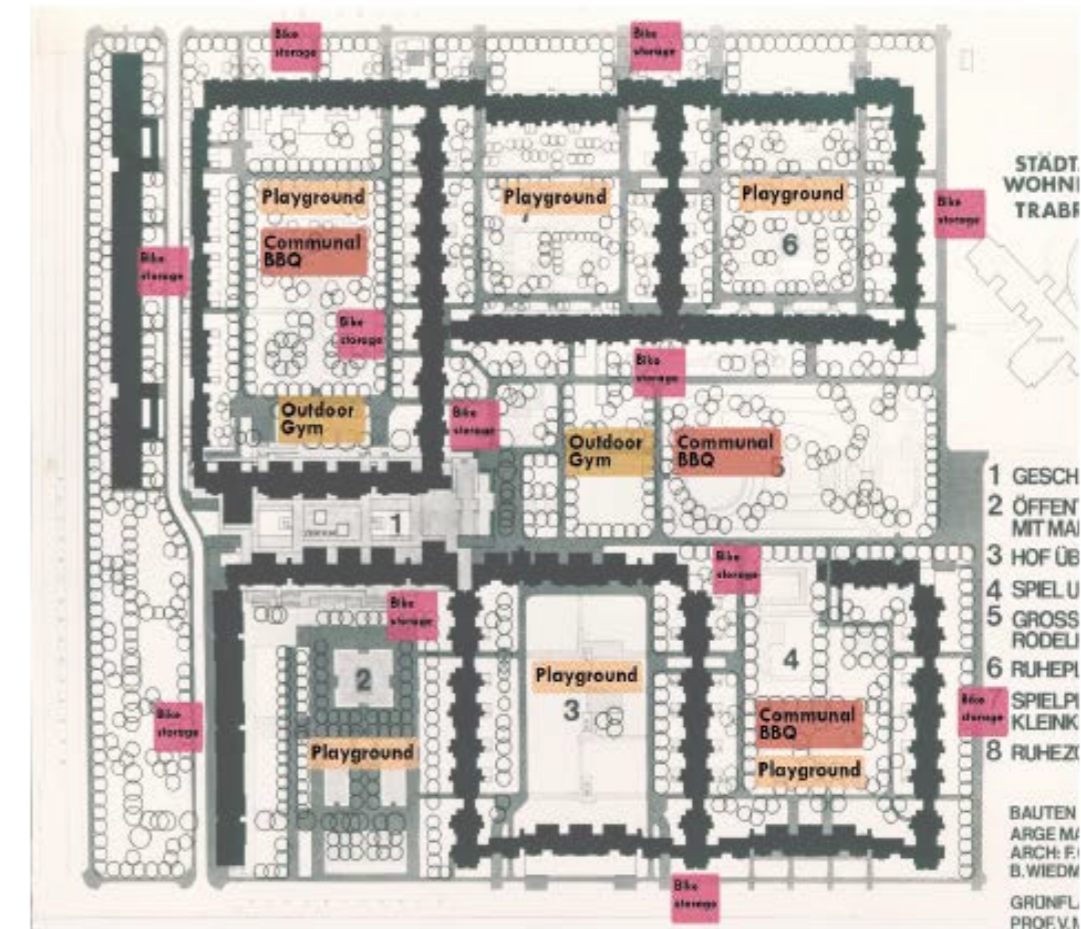

- The courtyards at the moment don't have real functions that are in the original plans
- We planned new playground in every courtyard because families with children needs playgrounds that are near them
- We planned oute door gyms and communal BBQ places and an-other communal spaces that bring the community together in every courtyard and the whole housing estate
- We planned bike storage places in the densest areas

10. Conclusion

Attractiv Passages

- Easy acces
- Well lit
- Nice coulors
- Attracitve materials
- Greening



Social Entrances

- Sitting areas
- Easy acces
- Well lit
- Nice coulors
- Attracitve materials
- Greening



Inviting Greeen

- Open space
- Hidden buildings
- Easy Orientation
- Funktional Spaces



Shared Spaces

- Comunitygardens
- Comunityrooms
- Mixed use
- Muiltfunktional Spaces



The background is a collage of ten vertical aerial photographs. From left to right, the images show: a dark, possibly paved or water-filled area; a large, dark, irregularly shaped landmass; a large, light-colored, rectangular building or industrial structure; a dense residential area with many small houses; a large, dark, rectangular building or industrial structure; a large, dark, rectangular building or industrial structure; a large, dark, rectangular building or industrial structure; a large, dark, rectangular building or industrial structure; a large, dark, rectangular building or industrial structure; and a large, dark, rectangular building or industrial structure.

Thank you for your attention